

RevNo	Revision note	Date	Signature	Checked
-------	---------------	------	-----------	---------

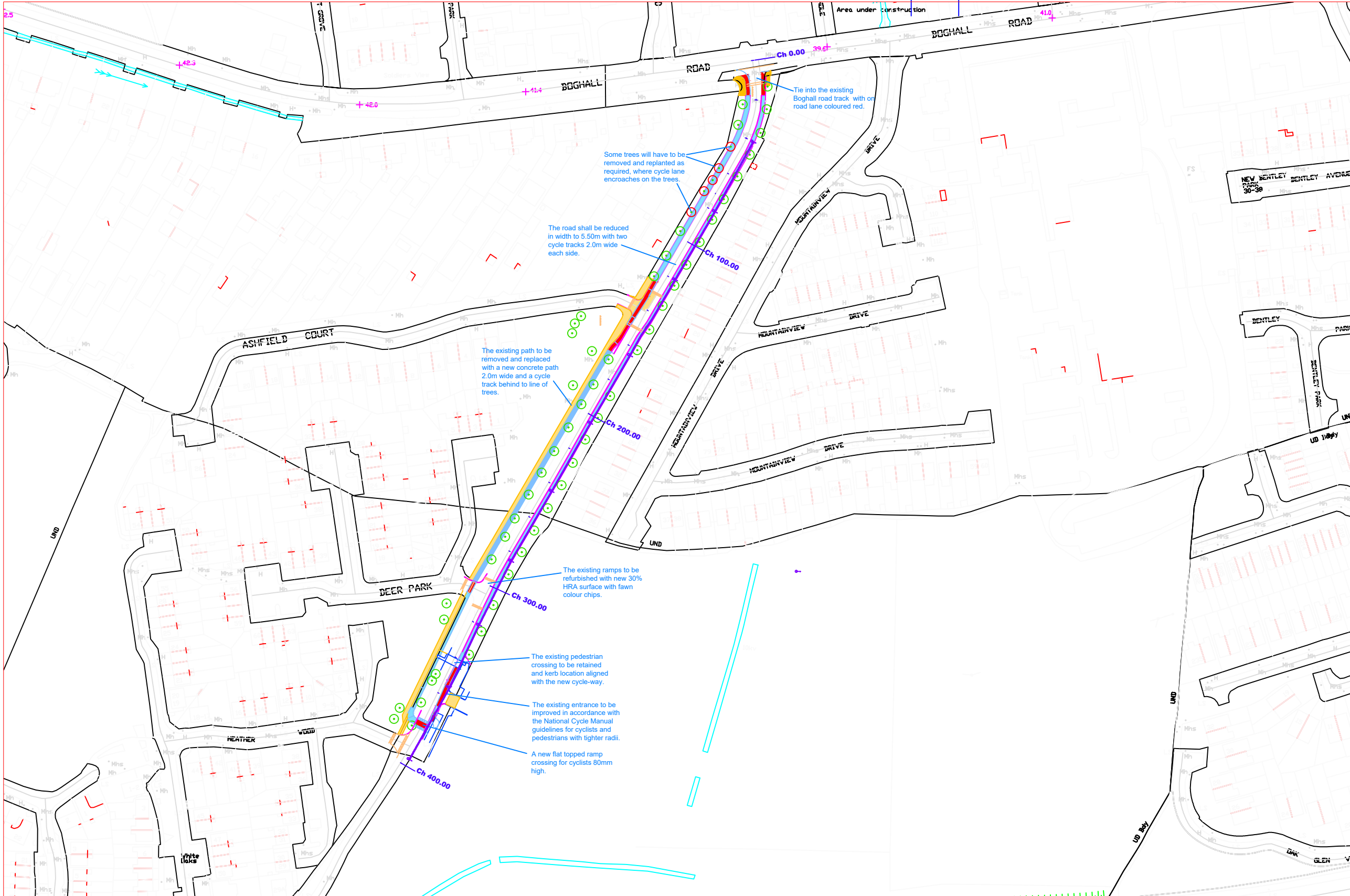

General notes for Part 8 process, Traffic calming and provision of Cycle tracks, new footpath and public lighting.

1. All existing ramps and road surface within the scope of the scheme shall be resurfaced.
2. In general the ramps shall be 80mm in height finished in 30% HRA with coloured buff chips to top of ramps, slope to ramps will be 1:15 in AC10, and 10mm SMA surface coarse to roads..
3. Kerb to be cast in situ extruded kerbs 225x225mm with 50mm show at finished road surface.
4. Cycle track crossings to be in red bauxite on epoxy resin surface.
5. New gully's shall be repositioned with new kerb alignment.
6. On the western side of the road the kerb radii at junctions shall be 3.0m.
7. The surface finish of the new cycle track shall be in 10mm SMA surface course.
8. New public lighting along the eastern side of the road and the western side of the path on the Deerpark green open space.
9. A new footpath and cycle track shall be constructed along the inside of the trees on the western side of the road replacing the old footpath, along with new public lighting.
10. A new ramped traffic calming cycle crossing shall be constructed south of the new supermarket entrance and pedestrian crossing.



Designed by DG	Checked by L Bourke	Approved by - date 3/03/22	Filename NTA_DP_2022	Date 03/03/22	Scale 1:2000
<b>Wicklow County Council</b> <b>Bray M.D.</b>			<b>Deerpark Cycle Scheme 2022</b>		
			<b>Layout sheet 1</b>		Edition 1